

This guide is designed as a reference to help you start using your LCD TV quickly. Please refer to the User's Manual for more detailed installation and safety instructions.

Front View

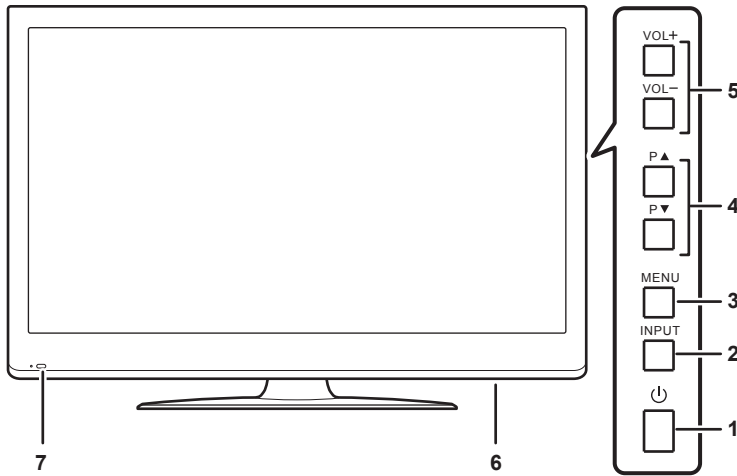

- | | |
|---------------------|------------------------------------|
| 1 Power | 5 Volume Adjustment |
| 2 Input Selection | 6 Speaker |
| 3 Menu | 7 Remote IR Sensor/Power Indicator |
| 4 Channel Selection | |

Rear View

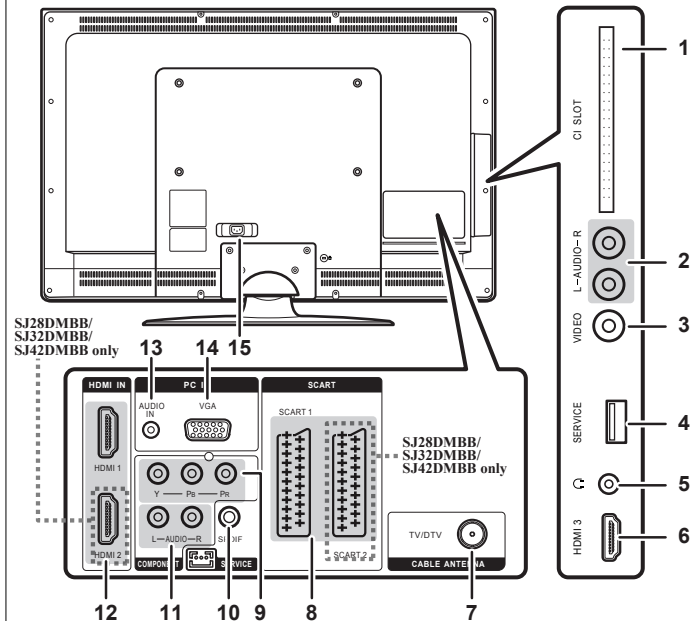

- | | |
|------------------------------|----------------------------|
| 1 CI | 9 Component Input (Video) |
| 2 Composite Inputs (Audio) | 10 SPDIF |
| 3 Composite Input (Video) | 11 Component Input (Audio) |
| 4 SERVICE (for service only) | 12 HDMI Inputs |
| 5 Earphone line out | 13 PC Audio IN |
| 6 HDMI Input | 14 PC VGA Input |
| 7 TV cable / antenna | 15 AC IN |
| 8 SCART IN/OUT | |

Making Connections

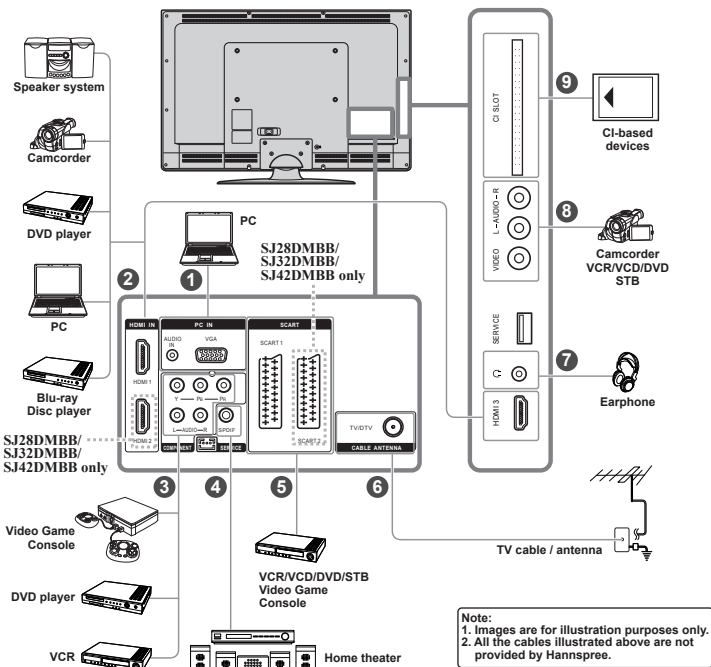

Connecting the Power Cord

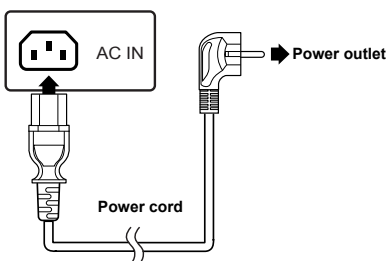

1. Plug the power connector into the AC IN input jack on the rear of the TV.
2. Insert the AC power plug at the other end of the power cord into a power outlet.
3. Press the Power button on the control panel or the remote control to turn the TV on.

Note: Images are for illustration only and may vary according to the model and region.

Running Setup Wizard

The Setup Wizard is displayed on the screen when you turn on your LCD TV for the first time.
Note: Use the \wedge , \vee to move through the menu. Press OK to select.

1. The Wizard appears to guide you through the initial setup. Press OK to start.
2. Select the Language for the on-screen display (OSD) menu.



3. Select the Country.
4. Press OK for channel scan.

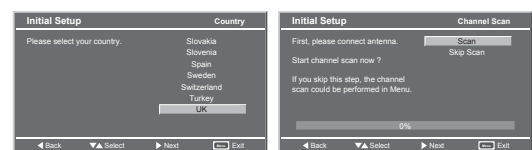

5. The channel scan may take a while to complete.
6. Press OK when channel scan is completed.

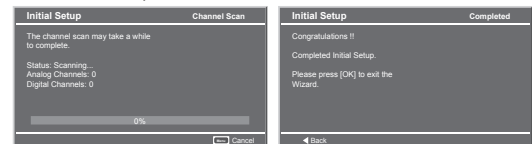

Watching Your TV

Selecting Your Content Source

You can watch cable or broadcast TV, play DVD or connect to your PC.

To select the source signal:

- Press the INPUT button on the remote control or the LCD TV. The Input Source menu appears.

- Press \wedge / \vee to highlight the desired source, then press OK to confirm.

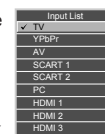

Selecting Channels

- Press the P \blacktriangle or P \blacktriangledown button on the remote control or the LCD TV to increase / decrease the program number; Or

- Press the numeric buttons on the remote control.