



SPP2327

P-Channel Enhancement Mode MOSFET

DESCRIPTION

The SPP2327 is the P-Channel logic enhancement mode power field effect transistor which is produced using super high cell density DMOS trench technology. The SPP2327 has been designed specifically to improve the overall efficiency of DC/DC converters using either synchronous or conventional switching PWM controllers. It has been optimized for low gate charge, low $R_{DS(ON)}$ and fast switching speed.

APPLICATIONS

- Powered System
- DC/DC Converter
- Load Switch

FEATURES

- ◆ $-110V/-1.0A$, $R_{DS(ON)} = 650m\Omega @ V_{GS} = -10V$
- ◆ $-110V/-0.5A$, $R_{DS(ON)} = 750m\Omega @ V_{GS} = -4.5V$
- ◆ High density cell design for extremely low $R_{DS(ON)}$
- ◆ Exceptional on-resistance and maximum DC current capability
- ◆ SOT-23-6L package design

PIN CONFIGURATION(SOT-23-6L)

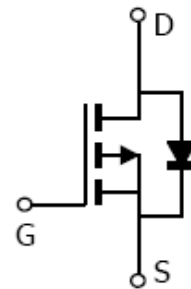
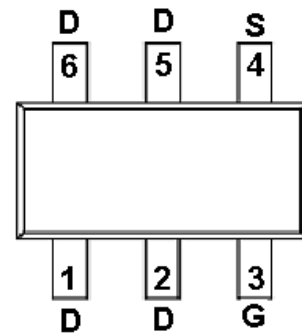

PART MARKING

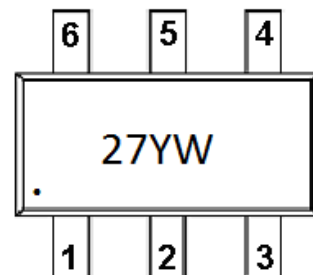



SPP2327

P-Channel Enhancement Mode MOSFET

PIN DESCRIPTION

Pin	Symbol	Description
1	D	Drain
2	D	Drain
3	G	Gate
4	S	Source
5	D	Drain
6	D	Drain

ORDERING INFORMATION

Part Number	Package	Part Marking
SPP2327S26RGB	SOT-23-6L	27YW

※ SPP2327S26RGB : Tape Reel ; Pb – Free ; Halogen – Free

ABSOLUTE MAXIMUM RATINGS (TA=25°C Unless otherwise noted)

Parameter	Symbol	Typical	Unit	
Drain-Source Voltage	V _{DSS}	-110	V	
Gate –Source Voltage	V _{GSS}	±20	V	
Continuous Drain Current(T _J =150°C)	I _D	TA=25°C	-1.5	A
		TA=70°C	-1.2	
Pulsed Drain Current	I _{DM}	-4.5	A	
Power Dissipation	P _D	TA=25°C	1.15	W
		TA=70°C	0.8	
Operating Junction Temperature	T _J	-55/150	°C	
Storage Temperature Range	T _{STG}	-55/150	°C	
Thermal Resistance-Junction to Ambient	R _{θJA}	100	°C/W	



SPP2327

P-Channel Enhancement Mode MOSFET

ELECTRICAL CHARACTERISTICS (T_A=25°C Unless otherwise noted)

Parameter	Symbol	Conditions	Min.	Typ	Max.	Unit	
Static							
Drain-Source Breakdown Voltage	V _{(BR)DSS}	V _{GS} =0V, I _D =-250uA	-110			V	
Gate Threshold Voltage	V _{GS(th)}	V _{DS} =V _{GS} , I _D =-250uA	-1	-1.5	-2.5		
Gate Leakage Current	I _{GSS}	V _{DS} =0V, V _{GS} =±20V			±100	nA	
Zero Gate Voltage Drain Current	I _{DSS}	V _{DS} =-80V, V _{GS} =0V, T _J =25°C			10	uA	
		V _{DS} =-80V, V _{GS} =0V T _J =55°C			100		
On-State Drain Current	I _{D(on)}	V _{DS} =V _{GS} =0V	-		-1.5	A	
Drain-Source On-Resistance	R _{DSON}	V _{GS} = -10V, I _D =-1A		0.52	0.65	Ω	
		V _{GS} = -4.5V, I _D =-0.5A		0.6	0.75	Ω	
Forward Transconductance	g _{fs}	V _{DS} =-10V, I _D =-1A		2.9		S	
Diode Forward Voltage	V _{SD}	I _S =-1A, V _{GS} =0V			-1.2	V	
Dynamic							
Total Gate Charge	Q _g	V _{DS} =-50V, V _{GS} =-10V I _D =-1A		9.3		nC	
Gate-Source Charge	Q _{gs}			1.75			
Gate-Drain Charge	Q _{gd}			1.25			
Input Capacitance	C _{iss}	V _{DS} =-15, V _{GS} =0V f=1MHz		553		pF	
Output Capacitance	C _{oss}			29			
Reverse Transfer Capacitance	C _{rss}			20			
Turn-On Time	t _{d(on)}	V _{DD} =-50V, I _D =-0.5A, V _{GS} =-10V, R _G =3.3Ω		2		nS	
	t _r			18.4			
Turn-Off Time	t _{d(off)}				19.6		
	t _f				19.5		



SPP2327 P-Channel Enhancement Mode MOSFET

TYPICAL CHARACTERISTICS

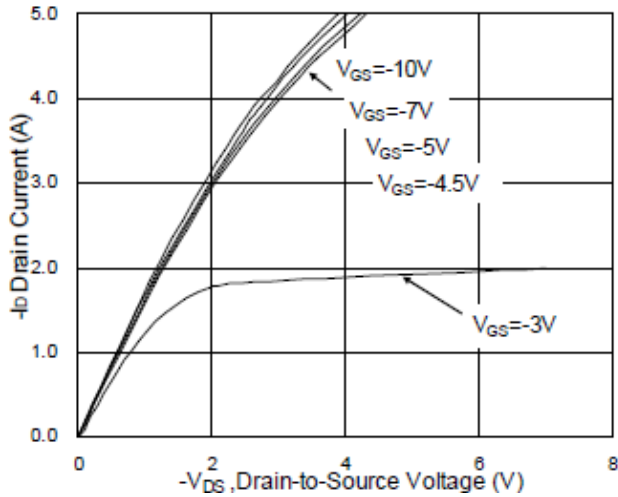

Fig 1 Output Characteristics

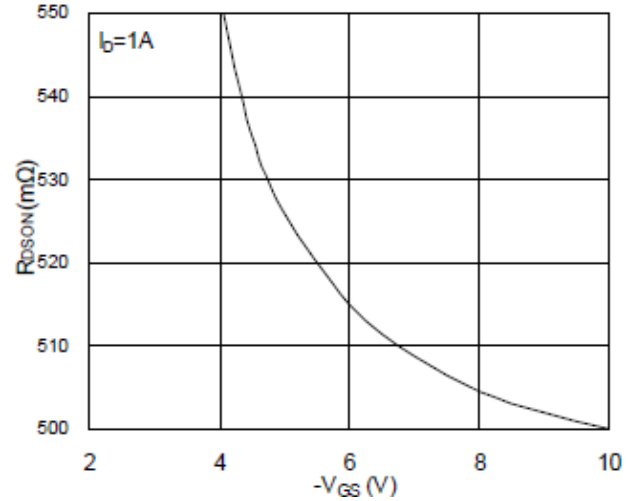

Fig. 2 On-Resistance vs Gate Source Voltage

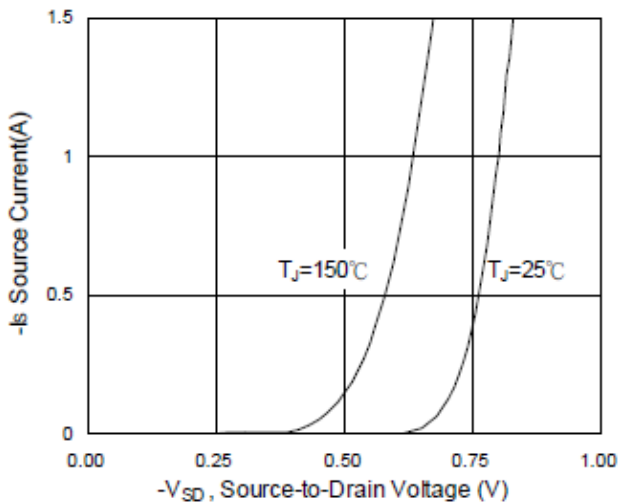

Fig 3 Source-Drain Forward Voltage

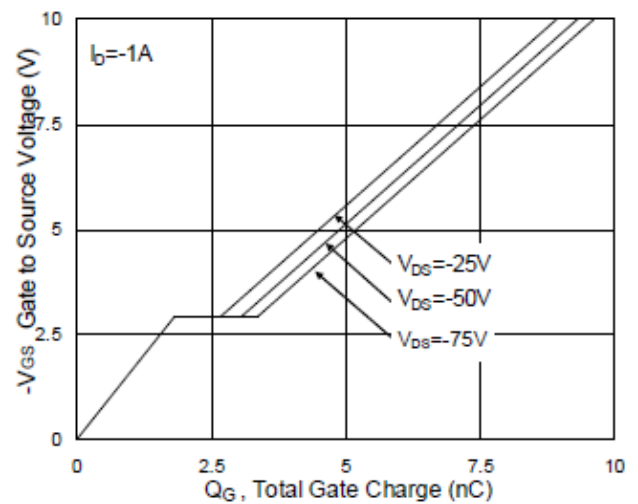

Fig. 4 Gate Charge

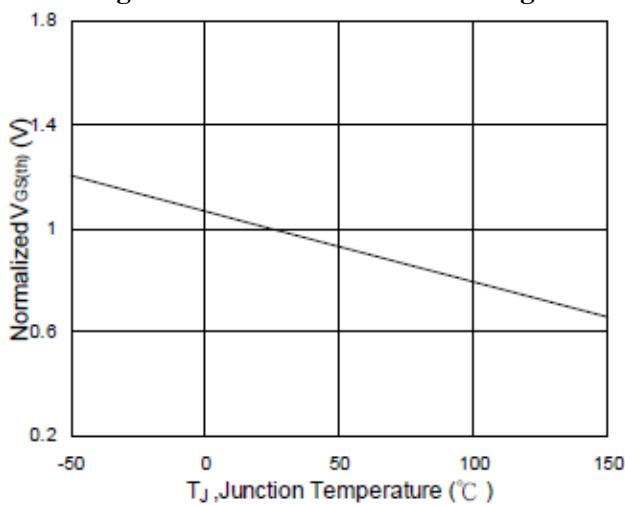

Fig. 5 Gate Voltage vs Junction temperature

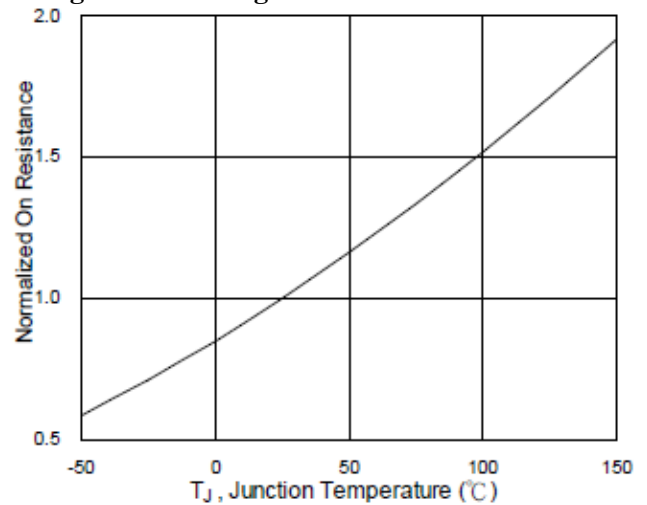

Fig. 6 On-Resistance vs Junction Temperature



SPP2327

P-Channel Enhancement Mode MOSFET

SOT-23-6L PACKAGE OUTLINE

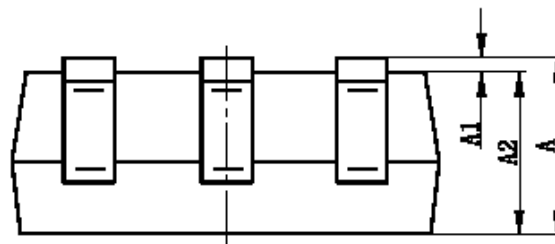
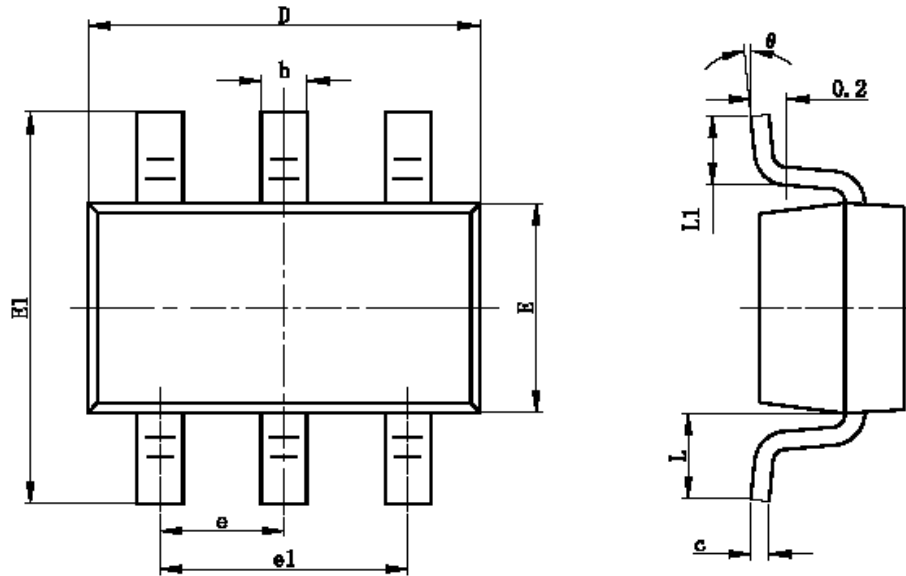

Symbol	Dimensions In Millimeters		Dimensions In Inches	
	Min	Max	Min	Max
A	1.050	1.250	0.041	0.049
A1	0.000	0.100	0.000	0.004
A2	1.050	1.150	0.041	0.045
b	0.300	0.400	0.012	0.016
c	0.100	0.200	0.004	0.008
D	2.820	3.020	0.111	0.119
E	1.500	1.700	0.059	0.067
E1	2.650	2.950	0.104	0.116
e	0.950TYP		0.037TYP	
e1	1.800	2.000	0.071	0.079
L	0.700REF		0.028REF	
L1	0.300	0.600	0.012	0.024
θ	0°	8°	0°	8°



SPP2327

P-Channel Enhancement Mode MOSFET

Information provided is alleged to be exact and consistent. SYNC Power Corporation presumes no responsibility for the penalties of use of such information or for any violation of patents or other rights of third parties which may result from its use. No license is granted by allegation or otherwise under any patent or patent rights of SYNC Power Corporation. Conditions mentioned in this publication are subject to change without notice. This publication surpasses and replaces all information previously supplied. SYNC Power Corporation products are not authorized for use as critical components in life support devices or systems without express written approval of SYNC Power Corporation.

©The SYNC Power logo is a registered trademark of SYNC Power Corporation

©2013 SYNC Power Corporation – Printed in Taiwan – All Rights Reserved

SYNC Power Corporation

7F-2, No.3-1, Park Street

NanKang District (NKSP), Taipei, Taiwan, 115, R.O.C

Phone: 886-2-2655-8178

Fax: 886-2-2655-8468

©<http://www.syncpower.com>