

REV	DESCRIPTION	BY	DATE	APPD
A	RELEASE PER NPR 2704A	JEM	1/14/02	[Signature]

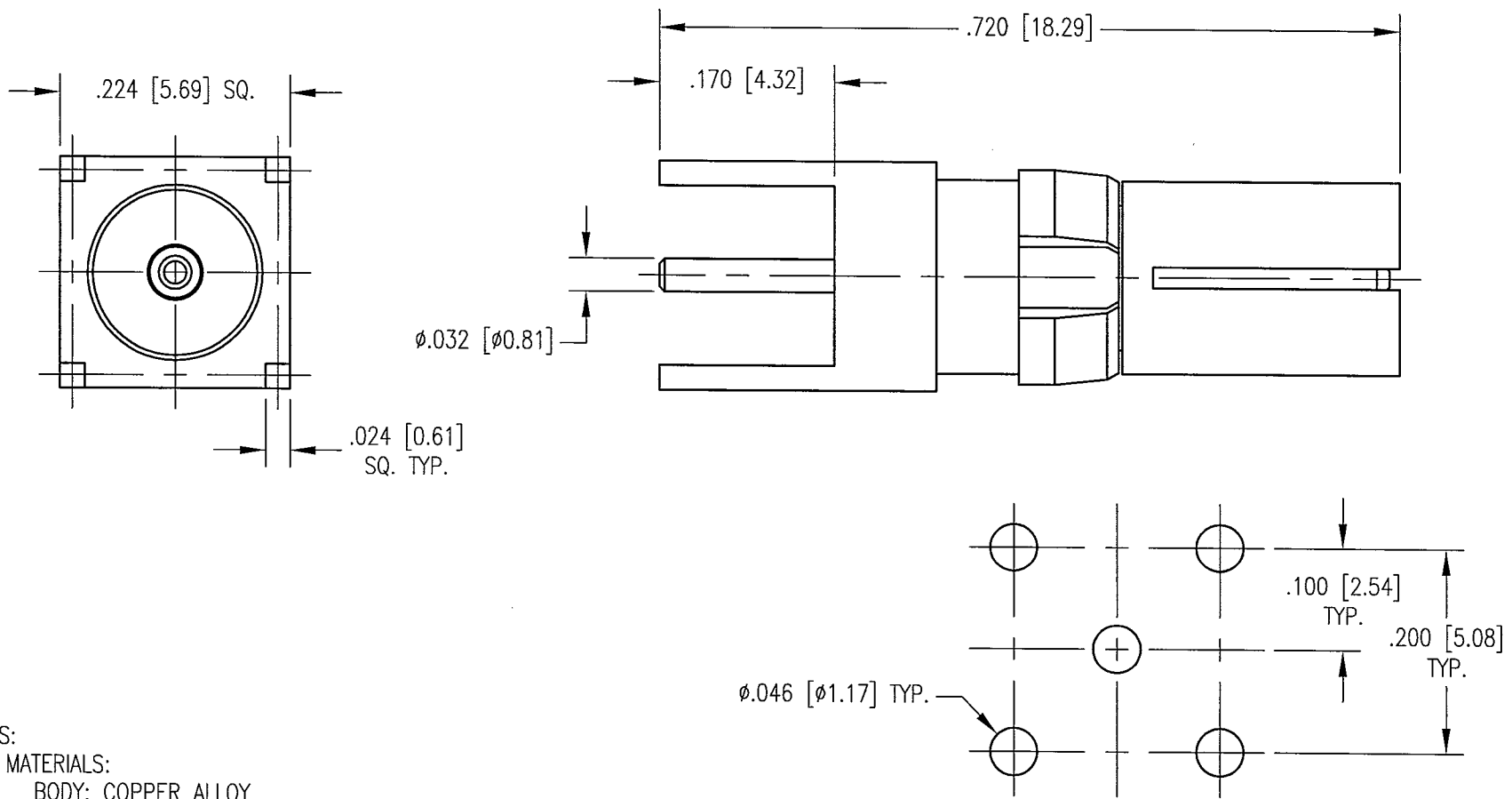

- NOTES:
- MATERIALS:
 BODY: COPPER ALLOY
 INSULATOR: TEFLON PER ASTM D1710
 CONTACT: BRASS PER ASTM B16
 CLIP RING: BERYLLIUM COPPER PER ASTM B194
 - FINISH:
 BODY AND CONTACT: .000030 MIN. GOLD PER MIL-G-45204 OVER
 .000050 MIN. NICKEL PER QQ-N-290
 CLIP RING: .000100 MIN. NICKEL PER QQ-N-290 OVER
 COPPER FLASH

RECOMMENDED MOUNTING HOLE

PER ASME Y14.5M-1994 UNLESS OTHERWISE SPECIFIED: DIMENSIONS ARE IN INCHES [MM]		Litton	
TOLERANCES: DECIMALS .XX ± .01/0.254 .XXX ± .005/0.127 ANGLES ± 2° SCALE: 6:1		Winchester/Retconn 400 Park Road Watertown, Connecticut 06795	
CUSTOMER DRAWING		TITLE 40 SERIES PCB STRAIGHT RECEPTACLE	
DRAWN JED	DATE 12/13/01	CHECKED JWH	DATE 12/14/01
APPROVED JEM	DATE 12/14/01	APPROVED KJT	DATE 12/14/01
A		401-010-6040G	
SHT.		OF	
1		1	
REV.		A	