

Rev	AWO #	Description	Date	Appr
-		RELEASED	5/25/10	

APPROVED: \_\_\_\_\_  
 DATE: \_\_\_\_\_ TITLE: \_\_\_\_\_

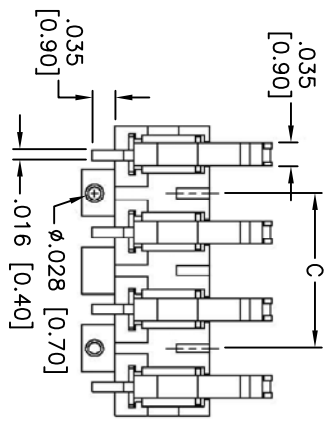
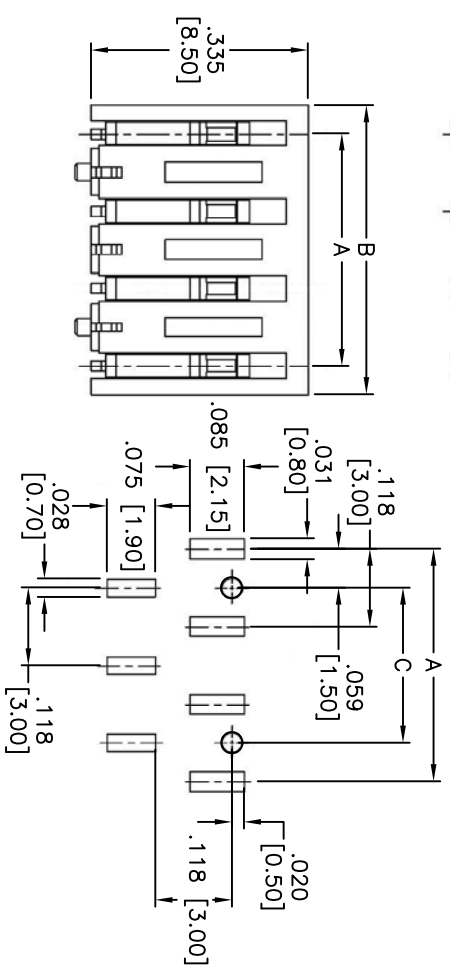
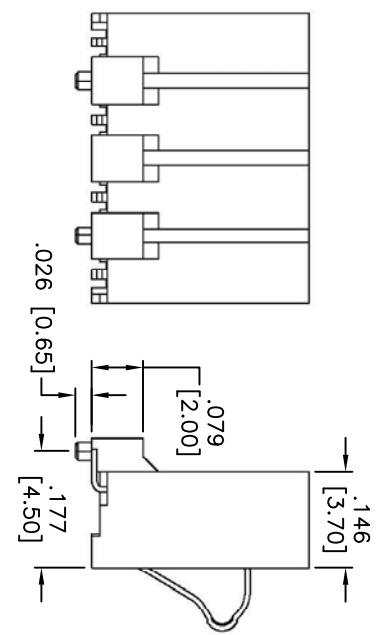
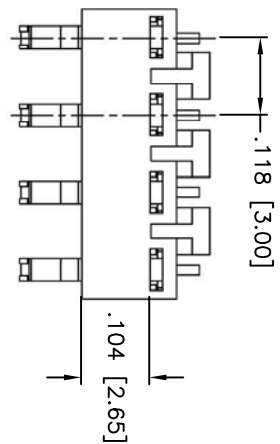

RECOMMENDED PCB LAYOUT

ADAM P/N	Pos.	A	B	C
MBC-D-3	3	.236 [6.00]	.323 [8.20]	.118 [3.00]
MBC-D-4	4	.354 [9.00]	.441 [11.20]	.236 [6.00]

# ADAM TECH

909 Rahway Avenue, Union, NJ 07083  
 Phone: 908-687-5000 Fax: 908-687-5710

TITLE: .118 [3.00] PITCH BATTERY CONNECTOR  
 SPRING TYPE, RIGHT ANGLE, SMT TYPE

**SPECIFICATION:**  
**Material:**  
 Insulator: Hi-temp plastic, Rated UL-94V-0  
 Insulator color: Black  
 Contacts: Copper Alloy  
**Plating:**  
 Gold flash over Nickel underplate on contact area,  
 Tin over Copper underplate on solder tails.  
**Electrical:**  
 Operating Voltage: 250V AC/DC  
 Current rating: 1A AC/DC Max.  
 Contact resistance: 30 Mohms Max.  
 Insulator resistance: 1000 Mohms Min @ 100V DC  
 Withstanding voltage: 500V AC/minute  
 Environmental:  
 Lead free, RoHS compliant.  
 Recommended soldering temp: 260°C for 5 sec.



UNLESS OTHERWISE SPECIFIED  
 ALL DIMENSIONS ARE NOTED  
 TOLERANCES: EXCEPT AS NOTED  
 INCHES  
 .X ±.10 ØXX ±.10  
 .XX ±.020 ØXXX ±.015  
 .XXX ±.015 ØXXXX ±.010

APPROVALS	DATE
DRAWN	5/25/10
CHECKED	
APPROVED	

SIZE	PART NO.	REV.
X	MBC-D-X	-

REF: S0014TT SCALE: NTS SHEET 1 OF 1