

CONDUCTIVE DUST CAPS

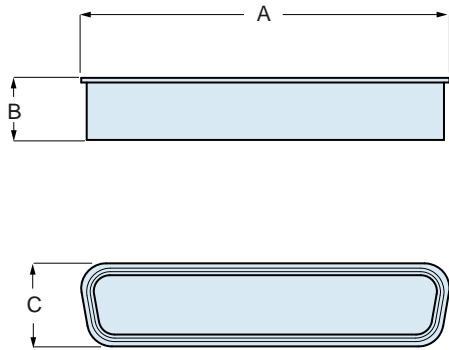

Black plastic conductive dust caps fit HiPer-D and M24308-type D-subminiature connectors. Molded in conductive polyethylene copolymer (EVA), these caps provide electrostatic discharge protection to sensitive equipment. 140°F maximum service temperature. These caps meet the static decay requirement of MIL-PRF-81705. Surface resistivity is less than 1×10^5 ohms/square. Integral lip allows easy removal.

Conductive Dust Caps								
Shell Size	Type	Part Number	A Max.		B Max.		C Max.	
			In.	mm.	In.	mm.	In.	mm.
1	Pin	289-052-1-P	.826	20.98	.300	7.62	.489	12.42
	Socket	289-052-1-S	.743	18.87	.283	6.93	.411	10.44
2	Pin	289-052-2-P	1.154	29.31	.300	7.62	.489	12.42
	Socket	289-052-2-S	1.071	27.20	.283	6.93	.411	10.44
3	Pin	289-052-3-P	1.694	43.03	.300	7.62	.489	12.42
	Socket	289-052-3-S	1.611	40.92	.283	6.93	.411	10.44
4	Pin	289-052-4-P	2.342	59.49	.300	7.62	.489	12.42
	Socket	289-052-4-S	2.259	57.38	.283	6.93	.411	10.44
5	Pin	289-052-5-P	2.239	56.87	.300	7.62	.601	15.27
	Socket	289-052-5-S	2.164	54.97	.283	6.93	.523	13.28
6	Pin	289-052-6-P	2.372	60.25	.300	7.62	.663	16.84
	Socket	289-052-6-S	2.289	58.14	.283	6.93	.586	14.88