

1. Mechanical Dimensions:

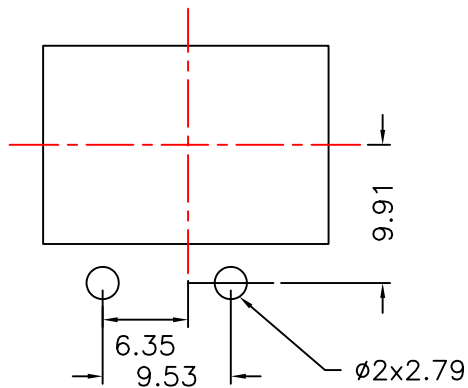
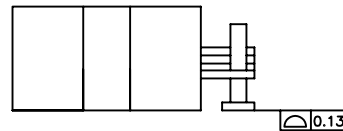
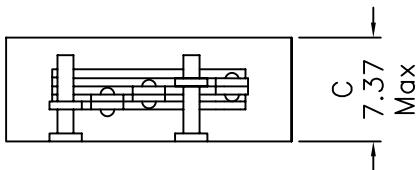
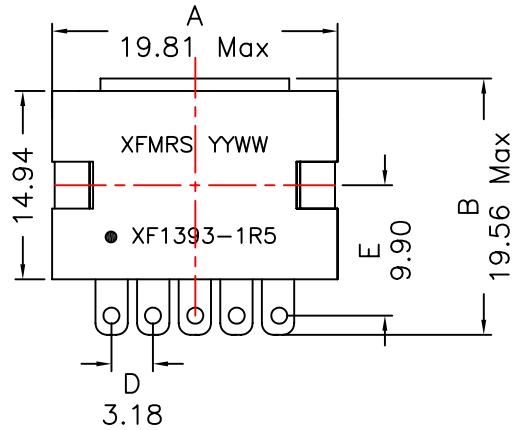

Suggested Pad Layout

DOC REV: A/1

2. Schematic:

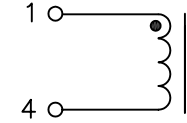

3. Electrical Specifications: (25°C)

OCL: 1.50uH±15% @10KHz 0.1V 0Adc
 1.40uH±15% @10KHz 0.1V 36Adc

DCR: 1.43mOhms Max

Rated: 36Adc

Heating Current: 42.0A (Based on 45°C Temp Rise)

Saturation Current Isat: 43A @25°C (Based on 15% drop in OCL)

35A @100°C (Based on 15% drop in OCL)

Notes:

1. Solderability: Terminals shall meet, IPC/EIA/JEDEC J-STD-002B
2. Flammability: UL94V-0
3. Operating Temperature Range: -40 to 125°C
4. Storage Temperature Range: -55°C to +125°C
5. Electrical and mechanical specifications 100% tested
6. RoHS Compliant Component

XFMRS Inc www.XFMRS.com	Title: SMT Power Inductors		
	UNLESS OTHERWISE SPECIFIED	P/N: XF1393-1R5	REV. A
TOLERANCES: .xx ±0.25	DWN.	Xianyi	Jun-01-11
Dimensions in MM	CHK.	YK Liao	Aug-05-09
Scale None SHT 1 OF 1	APP.	BW	Aug-05-09