

Rev	AWO #	Description	Date	Appr
-		RELEASED	9/10/10	

APPROVED: _____
 DATE: _____ TITLE: _____

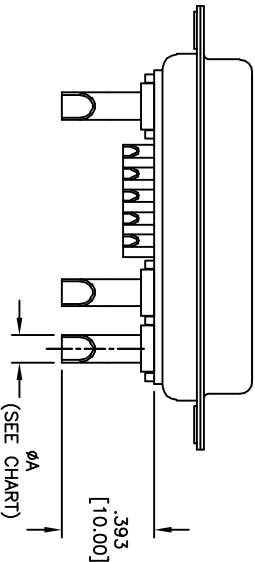
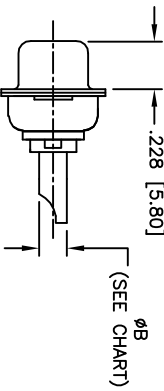
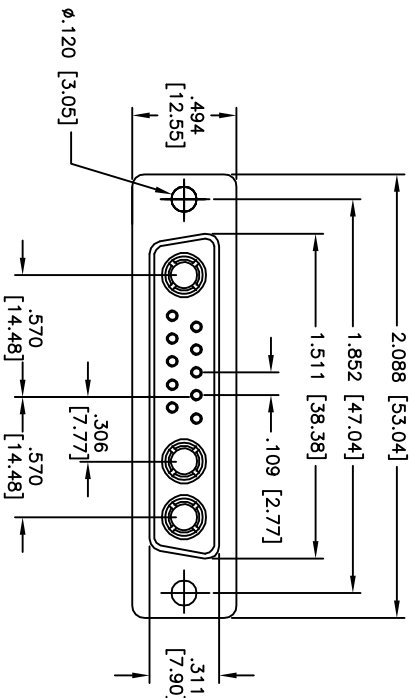

ADAM TECH PART NO.	CURRENT RATING	WIRE SIZE	DIMENSION	
			A	B
D13W3-SDP-61	40 AMPS	8-10 AWG	ϕ .181 [4.60]	ϕ .216 [5.50]
D13W3-SDP-51	30 AMPS	10-12 AWG	ϕ .146 [3.70]	ϕ .181 [4.60]
D13W3-SDP-41	20 AMPS	12-14 AWG	ϕ .106 [2.70]	ϕ .141 [3.60]
D13W3-SDP-31	10 AMPS	16-18 AWG	ϕ .067 [1.70]	ϕ .098 [2.50]

ADAM TECH

909 Rahway Avenue, Union, NJ 07083
 Phone: 908-687-5000 Fax: 908-687-5710

TITLE: D-SUB POWER SOCKET, D13W3, STRAIGHT, FEMALE, SOLDER CUP

UNLESS OTHERWISE SPECIFIED ALL DIMENSIONS ARE INCHES [MM]		TOLERANCES: EXCEPT AS NOTED	
INCHES		HOLE SIZE	
.X	\pm .10	ϕ XX	\pm .10
.XX	\pm .020	ϕ XXX	\pm .015
.XXX	\pm .015	ϕ XXXX	\pm .010
APPROVALS		DATE	
DRAWN	AY	9/10/10	
CHECKED	VW	9/10/10	
APPROVED		SIZE	PART NO.
		X	D13W3-SDP-X1
REF: S0009T		SCALE: NTS	SHEET 1 OF 1

SPECIFICATIONS:
 Material: PBT, 30% glass reinforced, rated UL 94V-0
 Insulator color: Black
 Contacts: Brass
 Shell: Steel, Tin plated
 Hardware: Brass, Nickel plated
 Plating:
 Gold flash over Nickel underplate overall
 Electrical:
 Operating voltage: 250 VAC max
 Current rating: 10 – 40 Amps max (See Chart)
 Contact resistance: 10 mohms max
 Insulation resistance: 5,000 Mohms min
 Dielectric withstanding voltage: 1,000 VAC for 1 minute
 Temperature Rating:
 Operating temperature: -55°C to +280°C
 Environmental:
 Lead free, RoHS compliant

