

PARTS LIST			
ITEM	QTY.	PART NO.	PART DESCRIPTION
1	1	F040014	P16 OA R11
2	1	F050404	50-004-04(INCANDESCENT BULB)
3	1	F052105	50-001-05 (WHT LNS TRANSPARENT)

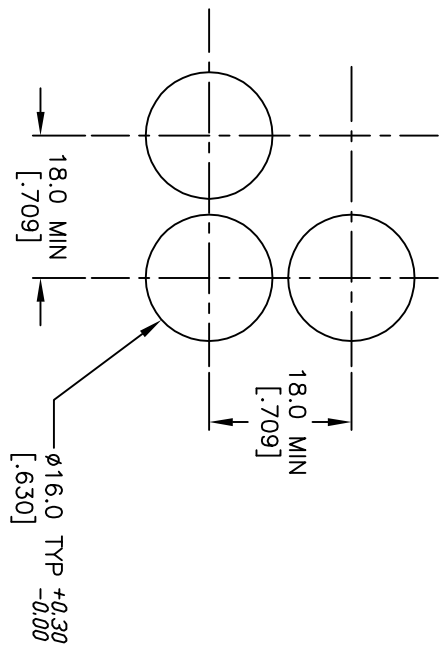

RECOMMEND PANEL MOUNTING

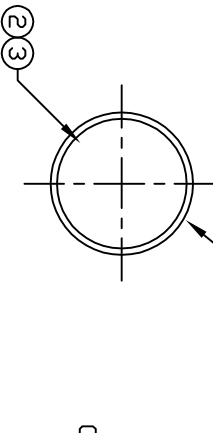

1.0 1.0 2  
3.0 0.4  
a-L-b (+)

CONTACT CONFIGURATION

NOTES:

1. ALL DIMENSIONS IN MM [INCH]
2. GENERAL TOLERANCE: X.X=±0.4 X.XX=±0.25
3. TERM. NOS. FOR REFERENCE ONLY.
4. RATING: 5A@250V AC / 8A@125V AC
5. MECHANICAL LIFETIME: >2 MILLION OPERATIONS
6. TRAVEL: 3.0MM
7. CONTACT MATERIAL: COPPER ALLOY W/SILVER PLATING
8. LAMP VOLTAGE: 14V AC/80mA DC

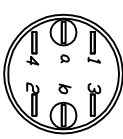
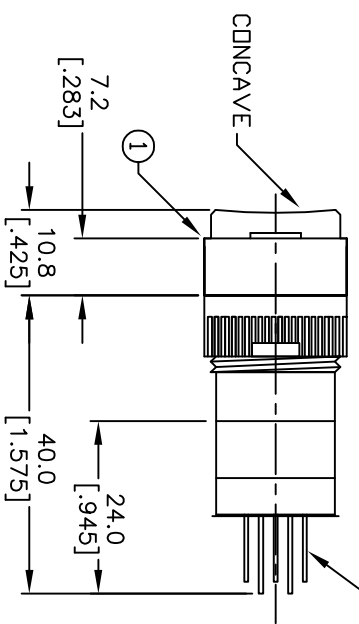

REV.	ECN NO.	DESCRIPTION	DATE	CHKD
A	18171	RELEASED FOR PRODUCTION	7/03/08	BLR

THE INFORMATION CONTAINED IN THIS DOCUMENT IS PROPRIETARY TO E-SWITCH AND IS NOT TO BE COPIED OR TRANSFERRED



TITLE: P16DAR11B WHT

SCALE	DATE	DR	DWG	REV
1.5:1	7/03/08	BLR	XF0333P	A