



VRLA Rechargeable Battery

MSB-2000 (2V, 2000Ah)



FEATURES

- Sealed structure, no electrolyte leakage or spill.
- High performance alloy to secure corrosion-proof feature.
- Unique electrolyte system achieves maximum service life.
- Low self-discharge rate, lower than 3% capacity loss per month.
- Special paste formula promotes the good charging acceptance.
- Electrolyte with gel technology.

APPLICATION

- Telecom
- UPS
- Central Office
- Energy Storage Systems



SPECIFICATIONS

Nominal Voltage	2 V
Nominal Capacity	2000Ah @ 10 hour rate F.V.(1.80V/cell)
Approx. Weight	153.0Kg(337.3lbs.)
Terminals	B6 (Fitting M8 bolt & nut)
Internal Resistance	≤ 0.4m Ω (Fully Charged)
Max. Discharge Current	7000 A (5 sec.)
Max. Charge Current	500 A
Operating Temperature Range	Charge : 0°C~40°C(32°F~104°F) Discharge : -20°C~50°C(-4°F~122°F) Storage. : -20°C~40°C(-4°F~104°F)
Safety Valve	Opening pressure 10~35 kPa
Container Material	Standard: ABS(UL 94-HB) MSB-2000 Optional: Flame Retardant ABS(UL 94-V0) MSB-2000FR



- IEC60896-21/22
- JIS C 8704-2
- GB/T19638.2
- YD/T799

DIMENSION(mm/inch)

OUTER DIMENSIONS

TERMINAL TYPE

Length

490±2.0 (19.29±0.08)

Width

350±2.0 (13.78±0.08)

Container Height

343±2.0 (13.50±0.08)

Total Height

371±2.0 (14.61±0.08)

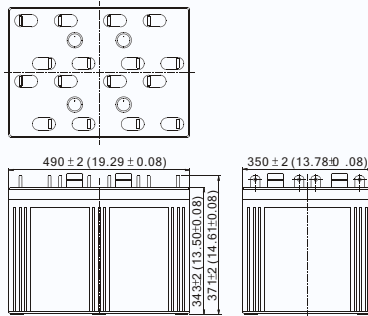

- Terminal B6

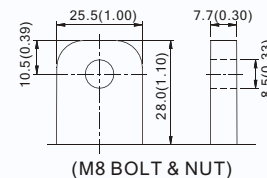

(M8 BOLT & NUT)

Terminal Hardware Initial Torque: 10.0 Nm ± 5%

Constant power discharge characteristics at 25 °C/77 °F

Unit: W

F.V. (V/cell) \ Discharge Time	30 Min	1 Hr	2 Hr	3 Hr	4 Hr	5 Hr	6 Hr	8 Hr	10 Hr	12 Hr	20 Hr
1.85V	2623.0	1800.0	1158.0	901.9	701.1	604.0	538.0	445.0	372.0	322.40	200.88
1.80V	2910.0	1980.0	1250.0	955.5	772.0	658.0	573.0	476.0	393.7	337.96	210.65
1.75V	3188.0	2100.0	1325.0	1006.0	808.8	688.0	598.0	491.0	411.2	349.55	216.92
1.70V	3500.0	2240.0	1370.0	1040.3	825.0	705.0	613.0	501.0	425.0	357.71	220.50
1.65V	3760.0	2310.0	1390.0	1061.5	842.0	715.0	625.0	510.0	431.0	362.76	222.37
1.60V	3835.0	2330.0	1410.0	1071.6	852.0	725.0	628.0	516.0	435.0	364.44	223.00

Constant current discharge characteristics at 25 °C/77 °F

Unit: A

F.V. (V/cell) \ Discharge Time	30 Min	1 Hr	2 Hr	3 Hr	4 Hr	5 Hr	6 Hr	8 Hr	10 Hr	12 Hr	20 Hr
1.85V	1400.0	960.0	610.0	471.6	370.0	313.1	270.0	220.0	187.0	162.07	100.98
1.80V	1560.0	1060.0	660.0	500.0	408.0	340.0	290.0	242.0	200.0	171.67	107.00
1.75V	1723.0	1130.0	703.0	529.4	428.0	360.0	310.0	253.0	211.0	179.35	111.30
1.70V	1910.0	1212.0	733.0	551.8	439.0	372.0	320.0	262.0	219.0	184.33	114.50
1.65V	2045.0	1261.0	753.0	570.1	450.0	382.0	332.0	270.0	223.0	186.69	116.00
1.60V	2150.0	1293.0	775.0	582.3	458.0	388.0	335.0	275.0	225.0	188.44	116.30

All data and artworks shall be changed without prior notice, BB reserves the right to explain and update the information contained hereinto.